

ENGLISH

PDI-200

V1

Ordercode: D1944

Warning



CAUTION!

Keep this device away from rain and moisture!
Unplug mains lead before opening the housing!



Every person involved with the installation, operation and maintenance of this system has to:

- be qualified
- follow the instructions of this manual



Return Procedure



Returned merchandise must be sent prepaid and in the original packing, call tags will not be issued. Package must be clearly labeled with a Return Authorization Number (RMA number). Products returned without an RMA number will be refused. Highlite will not accept the returned goods or any responsibility. Call Highlite 0031-455667723 or mail offersales@highlite.nl and request an RMA prior to shipping the fixture. Be prepared to provide the model number, serial number and a brief description of the cause for the return. Be sure to properly pack fixture, any shipping damage resulting from inadequate packaging is the customer's responsibility. Highlite reserves the right to use its own discretion to repair or replace product(s). As a suggestion, proper UPS packing or double-boxing is always a safe method to use.

Note: If you are given an RMA number, please include the following information on a piece of paper inside the box:

- 01) Your name
- 02) Your address
- 03) Your phone number
- 04) A brief description of the symptoms

Claims

The client has the obligation to check the delivered goods immediately upon delivery for any shortcomings and/or visible defects, or perform this check after our announcement that the goods are at their disposal. Damage incurred in shipping is the responsibility of the shipper; therefore the damage must be reported to the carrier upon receipt of merchandise.

It is the customer's responsibility to notify and submit claims with the shipper in the event that a device is damaged due to shipping. Transportation damage has to be reported to us within one day after receipt of the delivery.

Any return shipment has to be made post-paid at all times. Return shipments must be accompanied with a letter defining the reason for return shipment. Non-prepaid return shipments will be refused, unless otherwise agreed in writing.

Complaints against us must be made known in writing or by fax within 10 working days after receipt of the invoice. After this period complaints will not be handled anymore.

Complaints will only then be considered if the client has so far complied with all parts of the agreement, regardless of the agreement of which the obligation is resulting.

Description of the device

Features

The PDI-200 is a two-channel passive direct injection box. It converts your HI-Z signal into a LO-Z signal. You do not need a battery or phantom power for this box.

- Roadproof housing with rubber feet
- Compact size
- Low distortion
- Ground lift switch
- Attenuation switch (0dB, -20dB, -40dB)
- 20dB fixed natural attenuation
- 6,3 mm Jack input
- 6,3 mm Jack link connection
- Balanced 3-pin XLR output
- Dimensions: 140 x 110 x 55 mm (LxWxH)
- Weight: 1,1 kg
- No power supply needed

Overview

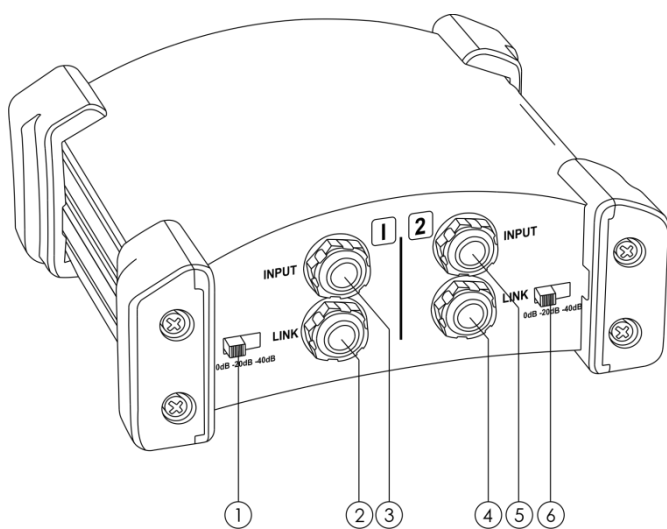

Fig. 01

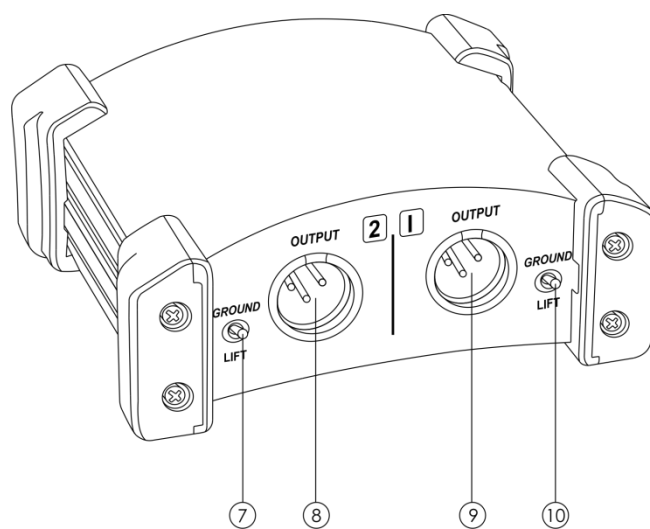

Fig. 02

- ① Input 1 attenuator
- ② Link output 1
- ③ Input 1
- ④ Link output 2
- ⑤ Input 2
- ⑥ Input 2 attenuator
- ⑦ Ground lift switch 2
- ⑧ Balanced 3-pin XLR output 2
- ⑨ Balanced 3-pin XLR output 1
- ⑩ Ground lift switch 1

01) Input 1 attenuator

Allows you to attenuate input 1 with:

- 0 dB for guitar type pickups.
- 20 dB for line level signals.
- 40 dB for speaker feeds.

02) Link output 1

The link output is wired in parallel with input 1, and can be used for connecting a speaker if the PDI-200 output is connected to an amplifier input.

03) Input 1

Connect this input to the output of your source device.

04) Link output 2

The link output is wired in parallel with input 2, and can be used for connecting a speaker if the PDI-200 output is connected to an amplifier input.

05) Input 2

Connect this input to the output of your source device.

06) Input 2 attenuator

Allows you to attenuate input 2 with:

- 0 dB for guitar type pickups.
- 20dB for line level signals.
- 40 dB for speaker feeds.

07) Ground lift switch 2

Allows you to remove the internal connection to output 1 pin 1, isolating the PDI-200 grounding system from that of the rest of the system.

08) Balanced XLR output 2

Connect this output to the input channel of your destination device.

09) Balanced XLR output 1

Connect this output to the input channel of your destination device.

10) Ground lift switch 1

Allows you to remove the internal connection to output 2 pin 1, isolating the PDI-200 grounding system from that of the rest of the system.

Applications

01) Guitar pick-up feed

The low level, high impedance signal of the guitar pickup is transformed by the PDI-200 into a high level, low impedance balanced signal required by the front of house mixer.

Suggested attenuator setting: 0 dB.

02) Keyboards line level feed

The unbalanced line level output of a keyboard can be balanced and matched by the PDI-200. In multiple keyboard setups where a mixer/ amp is used for monitoring, the PDI-200 can be used to save on separate direct boxes for each keyboard. In this case, either a line output or a speaker output can be used to feed the direct box, depending on the mixer/amp.

Suggested attenuator setting: : 0 dB (line level) or -20dB (amp level).

03) DJ-console feed

Interfacing additional equipment such as DJ mixers with the house console and PA may cause level and connector difficulties. Connect the DJ mixer to the jack input of the PDI-200 and then the PDI-200 output XLR to the house console.

Suggested attenuator setting: 0 dB or -20dB.

04) Speaker feed

Taking a feed from the amplifier output allows the post amplifier signal to be fed to the mixer, meaning that a particular amp sound can be send to the mixer.

Suggested attenuator setting: -40 dB.

Specifications

Frequency response:	30 Hz-50.000 Hz (1dB)
Distortion (THD):	0,003% at 400 Hz
Input:	2x 6,3 mm Jack
Link connection:	2x 6,3 mm Jack
Output:	2x balanced 3-pin XLR
Input impedance:	50.000 Ω
Output impedance:	500 Ω
Ground lift:	2x ground lift switch
Fixed natural attenuation:	20 dB
Attenuation settings:	0dB, -20dB, -40dB
Housing:	Roadproof with rubber feet
Dimensions:	140 x 110 x 55 mm (LxWxH)
Weight:	1,1 kg

Design and product specifications are subject to change without prior notice.



Website: www.Dap-audio.info
Email: service@highlite.nl

Dimensions

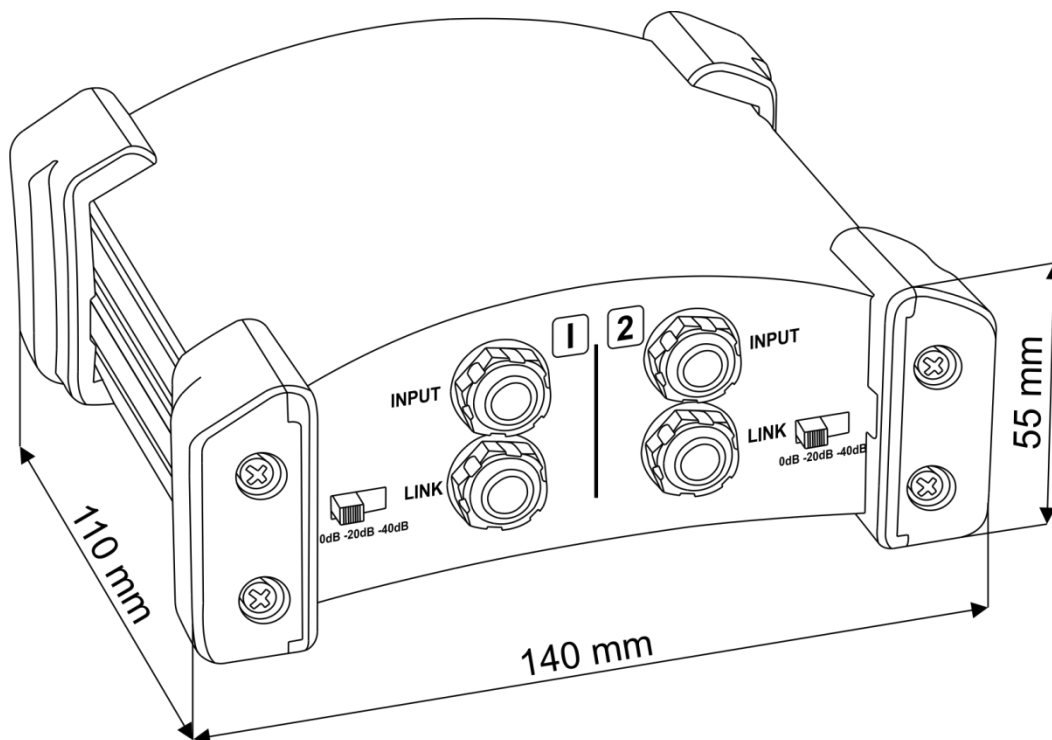



©2015 DAP Audio